





KIT ADMISSION DIRECTE DIRECT INDUCTION KIT

VW POLO 16V

S.A.S.
Chrono'Sport
122 rue du faubourg Saint Jean
ZA de l'AVELON - 60000 BEAUVAIS -
FRANCE

 00.33.3.44.02.64.64

 00.33.3.44.02.87.10

Part n° :P99

FITTING INSTRUCTION

- 1)- Remove complete air box.
- 2)- Fit the GREEN kit to the throttle box of the inlet manifold.
- 3)- Fit the small GREEN filter with the connector to the flexible breather pipe.
- 4)- Put the GREEN adaptor on the radiator housing, position to the side and in front of the route behind the radiator grill.
- 5)- Draw round inside and outside with a felt pen or marker pen
- 6)- Drill 4 6.5 mm diameter holes through adaptor then cut out the interior drawing of the adaptor.
- 7)- Once cutting is done, fix the adaptor to the radiator housing with the screws provided in the kit.
- 8)- Fit and tighten the aluminium sleeve onto the adaptor then it must bent round the motor to go up to the GREEN filter and fix it with the plastic clamps provided in the kit.

ORIGINAL FITTING

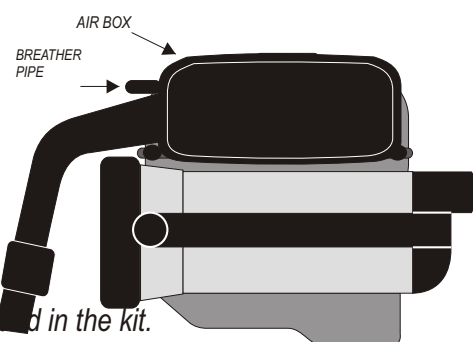

SIDE VIEW

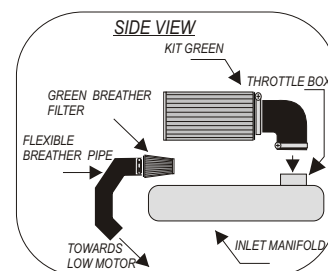

FITTING WITH THE GREEN DIRECT INDUCTION

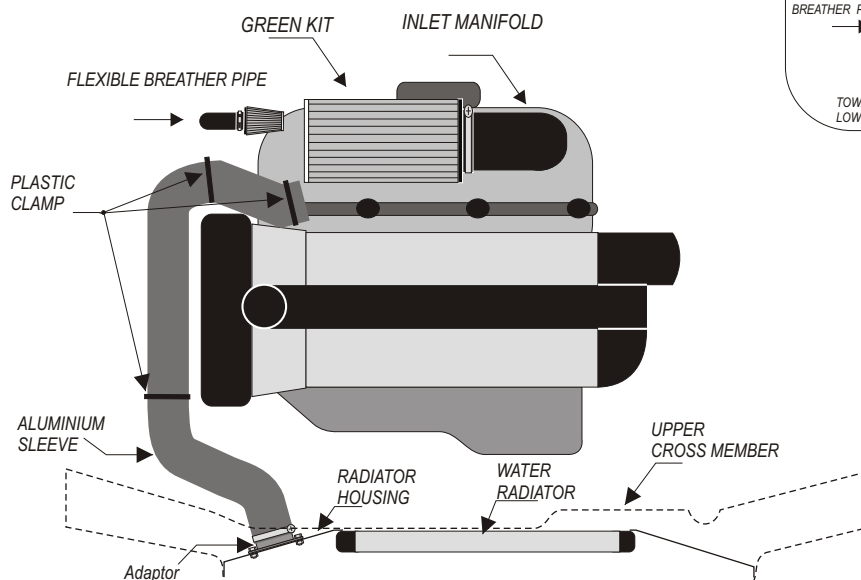

IMPORTANT:

The running of your engine is linked directly with the maintenance of the air filter. Clean your air filter every 7000 kms or 4500 miles with Green cleaning products..

WARRANTY:

The air filter guarantee is for defects in materials and workmanship only. Guarantee is void if the air filter is damaged by an accident, unreasonable use, neglect, misuse, abuse, improper installation or other causes not arising out of defects in materials and workmanship. The induction kit is a technical product so it is necessary to have some basic mechanical skills. If problems do not hesitate to have your induction kit fitted by a professional.

Green Technical dept : TEL: 00.33.3.44.02.64.64